

## 415 SERIES, 425 SERIES, 450 SERIES Pipe Connecting: Safety Quick Couplings

The 415/425/490 RapidLOK® Series Connector is an all purpose lightweight quick coupling designed for leakproof operation at a wide range of temperatures. The metal-to-metal seal further enhances the seal as temperature changes are encountered. The safety ring ensures safe venting of any residual pressure.

### Features

- The RapidLOK® 415/425/490 series couplings can perform equal to the respective pipe schedules
- Repeatedly reusable metal-to-metal seal with an optional secondary enviro o-ring seal
- No bolts, or hub clamps for faster hook-ups
- Unique automatic safety feature vents residual pressure
- No special heat treatment of seal rings required
- Only light torque required when tightening to rated pressure
- Compact and available in any combination, of threaded, butt weld or male socket weld ends
- Designed and tested to ASME B31.1, & B31.3
- Available in 3/4" - 2" sizes
- Materials: 316 Stainless Steel and Carbon Steel

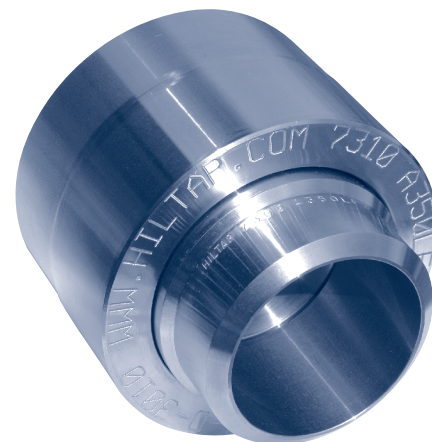

## SaVD™ LITE GATE VALVE 390 SERIES - Safe Vent & Drain Safety Seal Cap/Hose Half

**"Lite" Series Safety Seal Cap**  
ANSI 800 and below

**Lite Series Hose Half**  
Assembly 390 Series

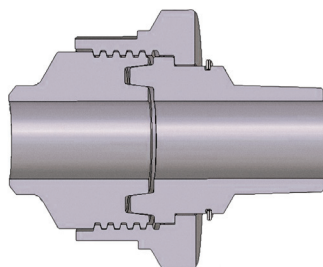

### Features & Benefits

- The SaVD™ Safety Seal Cap is designed to replace high pressure bull plugs used in venting & draining SAGD steam and heavy oil piping.
- Safety Seal Cap (with chain) can be retightened to seal
- Outer seal & locking threads are located OUTSIDE the wetted surfaces
- Valve mounted couplings halves can be safely rodged, steam cleaned, pressure purged with specially designed & CRN registered adapters.
- NACE materials of construction: Carbon Steel
- Solid Material Wedge, NO overlays
- Available in 3/4", 1", 1 1/2" and 2" sizes
- Available with butt weld, MNPT, or seal cap

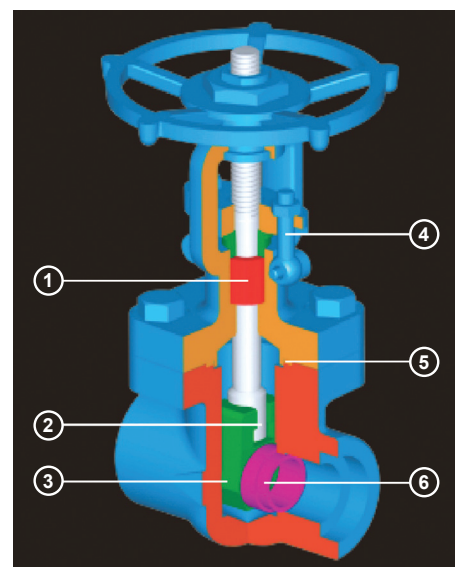

- ① Safe and tight stem seal by means of positive back seat and long life leak proof stuffing box design.
- ② The T-head connect of stem and disc assuring easy seating operation.
- ③ Solid fully guided wedge reducing wear on seating surfaces.
- ④ Gland eyebolts facilitating packing maintenance.
- ⑤ Leak proof Body-Bonnet Joint Cavity to eliminate the unwinding of the SS spiral metal.
- ⑥ Rolled-in seat to assure tight and effective seating.